

S482VHTY		S482VHTY		宁波市德隆机械有限公司	
设计	校对	审核	工艺	设计	校对
标准文件号	更改文件号	签名	年月日	设计标准	数量
1				1	
共 1 页		第 1 页		S482VHTY-(烟台金支集)	

S482VHY-T Part List

No.	Material No.	Description in English	Qty
1	70500620130	upper handrail	1
2	70520390130	lower handrail	1
3	70540084830	stop lever	1
4	70550074130	Self-propelled Lever	1
5	20340060000	foam pipe	1
6	20030030000	lever guard	1
7	60090250000	Hexagon head bolts	2
8	60150080000	Self-locking nut	2
9	70230090000	Rope Guide	1
10	60130020000	cap nut	4
11	20650170000	Brake Cable Assy plate	1
12	70780220000	selfpropelled cable	1
13	70810050000	brake cable	1
14	20580040830	quick fix knob	2
15	70220080000	quick fix handle	2
16	60300090000	lever pin	2
17	60240290000	open ring	2
18	60190040000	big flat washer	2
19	60200470000	flat washer	2
20	20040140830	small triangle knob	2
21	60140080000	Hex nut	2
22	60090240000	Hexagon head bolts	2
23	60150020000	hex self-locking nut	2
24	60090220000	Hexagon head bolts	2
25	70080250290	aluminum bracket-upper	2
26	60180130000	conical spring washer	2
27	70030850000	rotating shaft for quick lever	2
28	70220140830	aluminium quick lever	2
29	20240020000	fastener	1
30	20400140000	rear baffle	1
31	20400150000	rear baffle window	1
32	60170290000	ross recessed Pan head self-tapping screw	18
33	20380100000	rear discharge cover	1

34	70030830000	Shaft for rear discharge cover	1
35	60380590000	rear discharge cover spring -R L	1
36	60380580000	rear discharge cover spring -L	1
37	20390040000	the base of rear discharge cover	1
38	60170600000	Cross recessed Pan head tapping screws	8
39	20160190000	mulching plug	1
40	20750210000	rubber dust proof board	1
41	70030840000	dust proof board fis shaft	1
42	60300030000	R type pin	2
43	70850810000	rear drive assy	1
44	20260240000	height adjustment handle	1
45	20550050830	cover for height adjustment handle	1
46	60150170000	hex self-locking nut	2
47	60060530000	hex bolt	2
48	60200560000	big washer	2
49	60180120000	wave form washer	4
50	20610160000	inner cover of hub	2
51	20880460830	wheel assy	2
52	60150090000	hex self-locking nut	14
53	20620290290	outer cover of hub	2
54	70860500000	selfpropelled assy.	1
55	60290070000	Ratchet Wheel pin	2
56	20430030440	rear wheel axle sleeve	2
57	21070030000	selfpropelled ratchet washer	4
58	70300200000	Ratchet Wheel R	1
59	60240060000	spring washer	6
60	70300190000	Ratchet Wheel L	1
61	70050310000	Brake spring	1
62	60410560000	selfpropelled spring	1
63	70840310000	front drive assy	1
64	20610170290	inner cover of hub	2
65	20880470830	wheel assy	2
66	20620300290	outer cover of hub	2
67	60410660000	front drive spring	2

68	70180400830	Height Adjustment Pull Rod	1
69	60240300000	blocked plate	2
70	20200300000	front face mask	1
71	20200320830	front face screwing	1
72	20200310830	grass board	1
73	20200330830	front face plate cover	1
74	70080230290	aluminum low bracket-left	1
75	70080240290	aluminum low bracket-right	1
76	20590020000	cable stopper	1
77	60370020000	"O" ring	1
78	20460010000	inlet	
79	20460030000	outlet	1
80	60040160000	Half round head square neck bolts	4
81	70742070130	deck	1
82	70060120130	Bracket plate for defelctor	1
83	60170580000	Cross recessed Pan head tapping screws	2
84	70030820000	Mulch Shaft	1
85	60390250000	mulch board spring	1
86	20120120830	mulching board	1
87	20110160000	side discharge cover	1
88	60320270000	V belt	1
89	70070570130	front drive right bracket	1
90	70070560130	front drive left bracket	1
91	60040020000	Half round head square neck bolts	4
92	70290350000	rear drive bracket	2
93	20660240000	belt cover	1
94	60200530000	square washer	2
95	60080280000	double-head bolt	2
96	60060390000	hex tapping screws	1
97	70140780000	blade adapter	1
98	70130960000	blade	1
99	70040070000	blade washer	1
100	60100020000	bolt of blade	1
101	20080100830	top of grass box	1
102	20060060000	air-out board of fabric grass bag cover	1
103	20080110000	top grass box screwing	1
104	20100100000	lower of grass box - right	1
105	20100090000	lower of grass box - left	1

106	20060070830	grass sticker board	2
107	60171930000	plum flowe self-tapping screws	6
108	19980500000	T475 engine	1
109	60200550000	big washer	2
110	60200110000	flat washer	2
111	20650140000	control panel upper cover	1

T475-2汽油机分解图

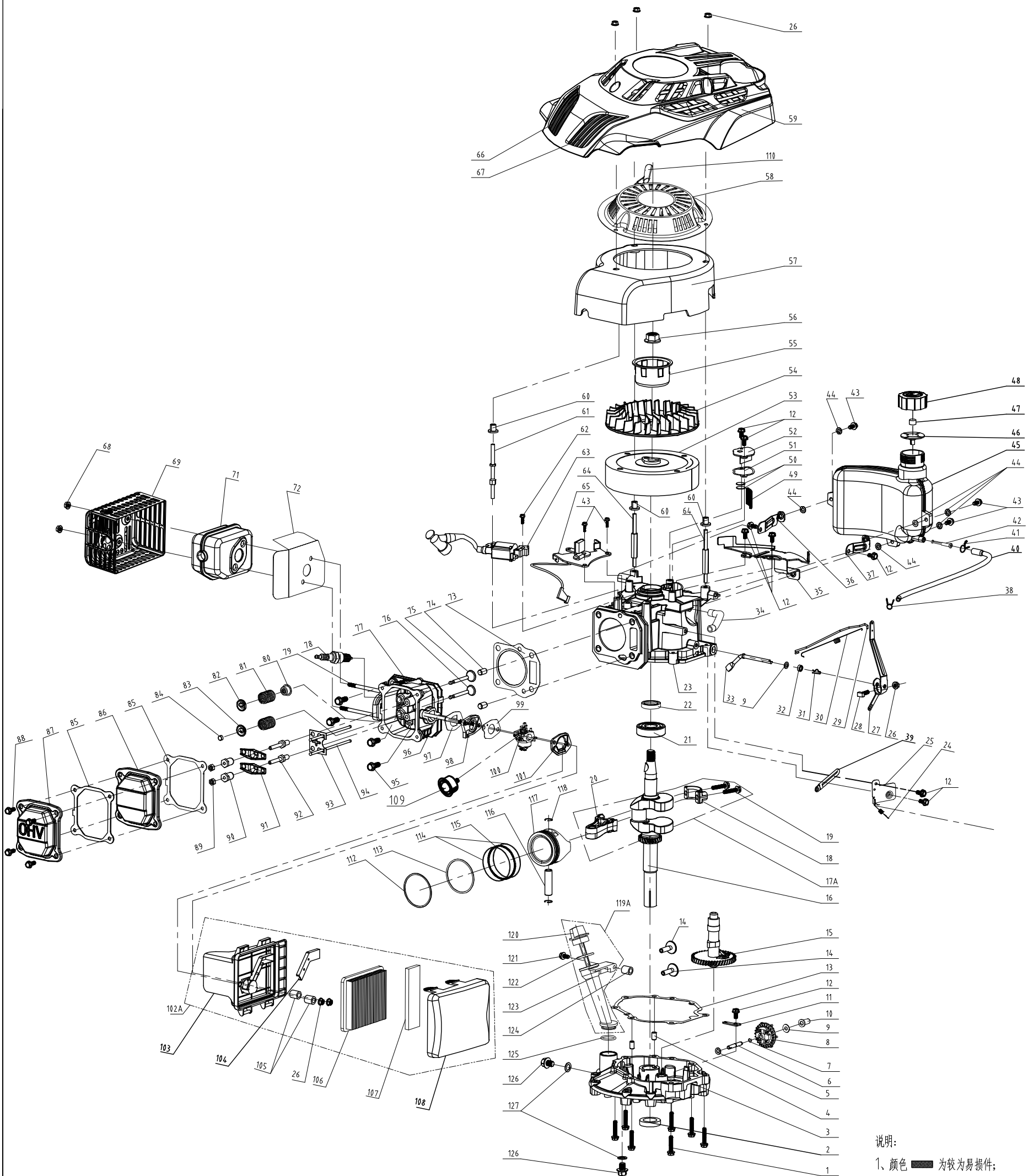

说明:

- 1、颜色 为较为易损件;
- 2、颜色 为一般易损件;
- 3、本图为带刹车装置不带调速。

修改/删除
 插图
 存盘文件名
 图库图号
 底图图号
 签字
 日期

						宁波市德霖机械有限公司			
						T475带刹车不带调速款			
标记	页数	分区	更改文件号	签名	年月日	阶段标记	数量	重量	比例
设计			标准化				1		1:4
校对			审定						
审核									
工艺			批准						
						共 1 页	第 1 页	版本 A1	

Poz.	Číslo	Poč.	Název
1	60060590000	7	Bolt
2	60360100000	1	oil seal
3	75240140000	1	Crank box cover
4	60280030000	2	spacing pin
5	60200060000	1	Gasket
6	75270010000	1	rate-limiting gear shaft
7		1	Gear Shaft circlip
8	75520020000	1	rete-limiting gear assy.
9	60200490000	2	Gasket
10	25070010000	1	Sliding Sleeve
11	75280010000	1	rate-limiting gear shaft
12	60060520000	11	Bolt
13	75720240000	1	
14	75250010000	2	pin
15	75470020000	1	camshaft assy.
16	75510600000	1	crankshaft assy.
17	75460020000	1	connecting rod assy.
18		1	
19		2	
20		1	
21	60010140000	1	rolling bearing
22	60360090000	1	oil seal
23	75500010000	1	crankshaft box
24	60410470000	1	throttle control spring
25	75360010000	1	throttle assy.
26	60150080000	6	Hex flange nuts
27	75070010000	1	throttle rocker arm
28	60060730000	1	bolt
29	75160010000	1	Handspike of Valve
30	60410050000	1	valve spring
31	60300040000	1	R type pin
32	60360080000	1	oil seal
33	75290010000	1	rate-limiting rocker arm shaft
34	25030020000	1	waste pipe
35	75330010000	1	main bracket of fuel tank
36	75310010000	1	right bracket of fuel tank
37	75340010000	1	left bracket of fuel tank
38	60230010000	1	fuel pipe lock clamp II
39	60450010000	1	clip
40	25160010000	1	fuel pipe
41	60230020000	1	fuel pipe lock clamp I
42	25150010000	1	
43	60060560000	3	Bolt
44	25310010000	6	Cushion Blocking gasket
45	25180130000	1	fuel tank body
46	60440030000	1	Fuel Tank Cap seal gasket
47	80010070000	1	fuel tank cap sponge
48	25170050000	1	fuel tank cap
49	75150010000	1	oil filter net
50	75100020000	2	
51	75720150000	1	
52	75400010000	1	Respirator Cover Plate Assy
53	75390130000	1	flywheel assy
54	25040110000	1	fan
55	75210010000	1	starter hub
56	60140050000	1	Hex flange nuts
57	25010010000	1	Blower Housing
58	75430110000	1	pull starter assy.
59	25190080000	1	
60		1	
61	60080100000	1	Different-shaped double-head bolts I
62	60060580000	1	Bolt
63	75370030000	1	ignition assy.

64	60080120000	2	Different-shaped double-head bolts BOM单
65	75380070000	1	detent assy.
66	25000020830	1	
67	25000030830	1	
68	60150100000	2	Self-locking nut
69	75530020000	1	muffler cover assy.
70			
71	75540020000	1	muffler assy.
72	75740020000	1	
73	75720100000	1	
74	60280020000	2	spacing pin
75	75170010000	1	IntakeValve
76	75190010000	1	Exhaust Valve
77	75490020000	1	cylinder head assy.
78	75140010000	1	spark plug
79	60080020000	2	Dual-head bolts
80	60360130000	1	oil seal assy
81	60380080000	2	valve spring
82	75180010000	1	Spring Coil of Intake Valve
83	75180020000	1	Spring Coil of Exhaust Valve
84	75200010000	1	Top Cover of Exhaust Valve
85	75720270000	2	
86	75220010000	1	cylinder head cover I
87	75220020000	1	cylinder head cover II
88	60060530000	4	Bolt
89	60160030000	2	And nuts
90	60160050000	2	Valve adjustment nut
91	75230010000	2	Rocker of Valve
92	60060760000	2	valve rocker arm support bolts
93	75260010000	1	push rod director plate
94	75350010000	2	push rod
95	60050030000	4	locking bolt
96	60080030000	2	Dual-head bolts
97	75730020000	1	
98	25090010000	1	Air Inlet Pipe
99	75730030000	1	
100	75410050000	1	carburetor assy.
101	75730100000	1	Steel Gasket
102			
103	25220010000	1	Air Filter Pedestal
104	25020010000	1	Exhaust Gas Cover Board
105		2	
106	25300020000	1	
107	25300010000	1	
108	25120010000	1	Air Filter Upper Cover
109	25210020130	1	prime button I
110		1	start handle
111			
112	75130060000	1	Piston Ring I
113	75130030000	1	Piston Ring II
114	75060010000	2	Guide Rail
115	75000010000	1	Bushing Ring
116	60310010000	1	piston pin
117	75120010000	1	Piston
118	60400020000	2	Piston Pin circlip
119	25200100130	1	Lubricating Gauge Assy
120		1	
121	60060570000	1	Bolt
122		1	
123		1	
124	25080010000	1	Distance Sleeve of Lubricating Setting
125		1	
126	60061020000	2	Oil drain bolt
127	60200150000	2	Oil drain bolt gasket