

# SNACK COLLECTION

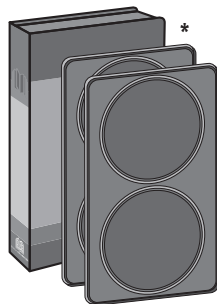

FR  
NL  
DE  
EN  
IT  
ES  
PT  
EL  
TR  
DA  
NO  
SV  
FI  
CS  
SK  
HU  
PL  
RU  
UK  
SL  
SR  
BS  
BG  
RO  
HR  
ET  
LT  
LV  
JA  
KO  
AR  
FA

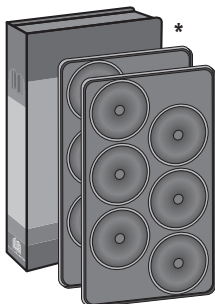

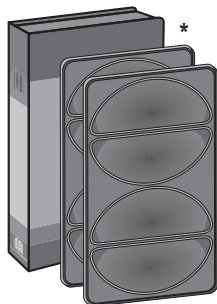
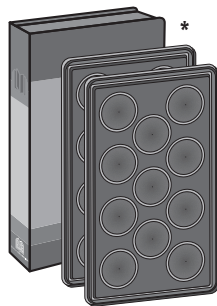
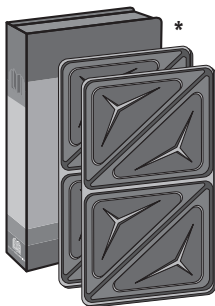
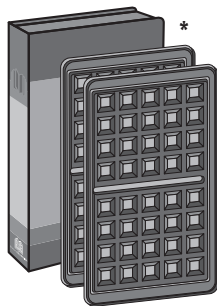
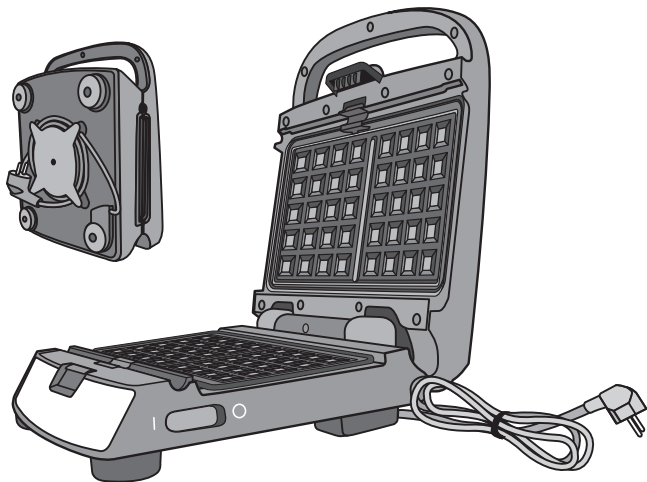
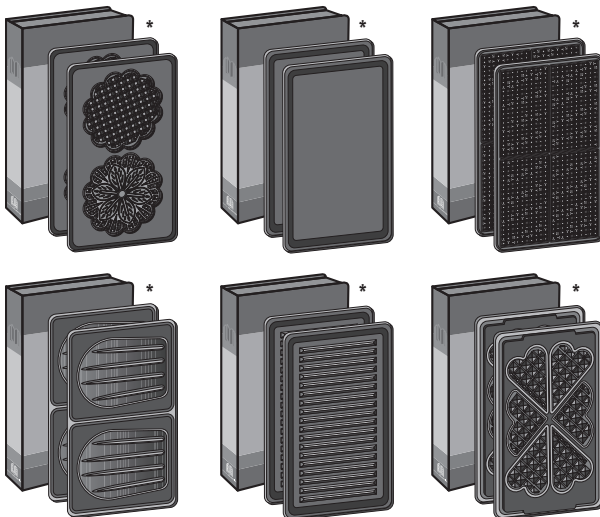

- \* FR : Selon modèles et/ou disponibles en magasin ou internet.  
 NL : Afhankelijk van het model en/of de beschikbaarheid in de winkel of online.  
 DE : Je nach Modell und / oder im Geschäft oder online erhältlich.  
 EN : Depending on the model and/or available in store or online.  
 IT : A seconda del modello e/o disponibile in negozio o online.  
 ES : Dependiendo del modelo y / o disponibles en la tienda o en línea.  
 PT : Dependendo do modelo e / ou disponível na loja ou online.  
 EL : Ανάλογα με το μοντέλο και/ή διατίθενται στα καταστήματα ή το Διαδίκτυο.  
 TR : Modele ve/veya mağazada ya da çevrimiçi olarak bulunabilirliğe bağlıdır.  
 DA : Afhængig af model og/eller rådighed i butikken eller online.  
 NO : Avhengig av modell og / eller tilgjengelig i butikken eller på nettet.  
 SV : Beroende på modell och/eller tillgänglighet i butik eller online.  
 FI : Riippuen mallista ja/tai saatavilla liikkeessä tai verkossa.  
 CS : Dostupnost v obchodě nebo online v závislosti na modelu a/nebo s předmětu.  
 SK : Dostupnosť v obchode alebo on-line v závislosti na modeli a/alebo s predmetom.  
 HU : Tipustól függően és/vagy az üzlet vagy az online bolt raktárkészletének függvényében.  
 PL : W zależności od modelu i/lub pod warunkiem dostępności w sklepie lub w Internecie.  
 RU : Зависит от модели и/или от наличия в продаже.  
 UK : Залежно від моделі та/або наявності в магазинах чи інтернет-магазинах.  
 SL : Ovisno od modela in razpoložljivosti izdelka v trgovini in/ali na spletu.  
 SR : Zavisno od modela i/ili zalaha ili onlajn dostupnosti.  
 BS : Zavisno od modela i/ili zalaha ili dostupnosti na mreži.  
 BG : В зависимост от модела и/или предмета на складава или онлайн наличност.  
 RO : În funcție de model și/sau de disponibilitățile din magazin sau online.  
 HR : Ovisno o modelu i/ili zalihama ili dostupnosti na mreži.  
 ET : Olenevalt mudelist ja/või kättesaadavusest laos või internetis.  
 LT : Priklausomai nuo modelio ir (ar) yra parduotuvėje ar internete parduotuvėje.  
 LV : Atkarībā no modeļa un/vai pieejamības noliktavā vai tiešsaistes veikalā.  
 JA : モデルおよび/もしくは店やオンラインで利用可能なものに応じて  
 KO : 모델에 따라 다름, 매장 또는 온라인에서 구입 가능.  
 AR : حسب الطراز وأو التوفر في المتجر أو عبر الإنترنت  
 FA : بسته به مدل و یا موجودی در فروشگاه یا به صورت آنلاین

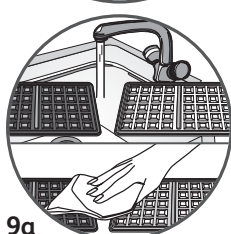
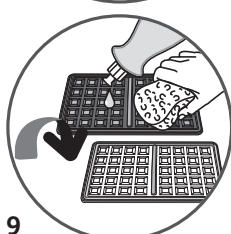
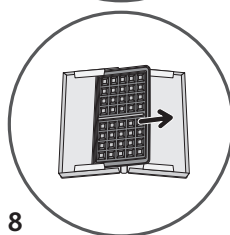
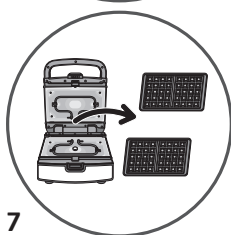
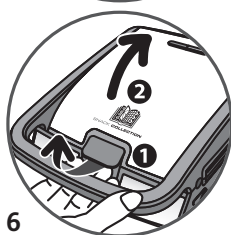
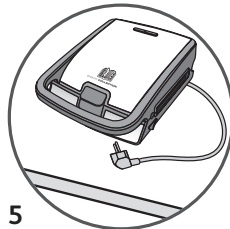
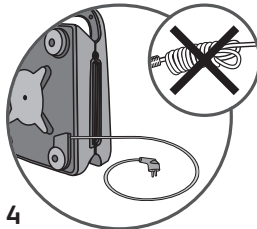
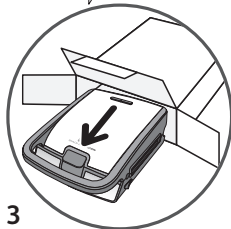
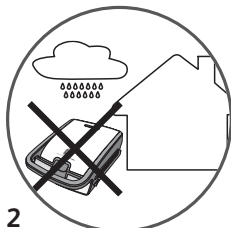

C

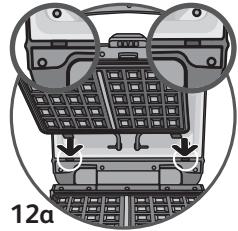
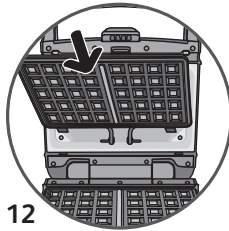
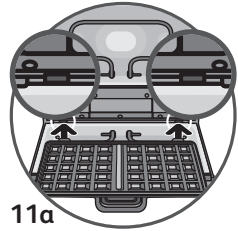
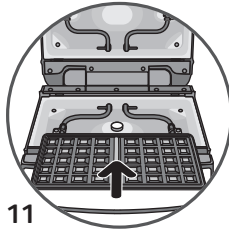
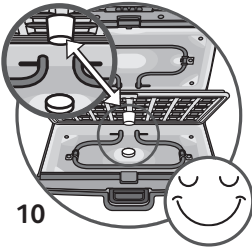

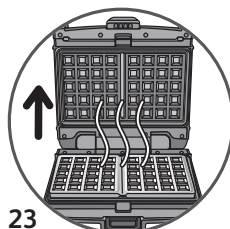
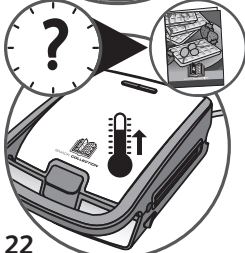
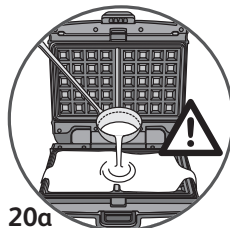
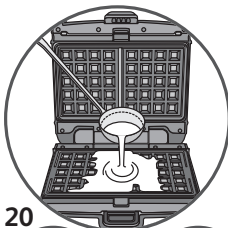
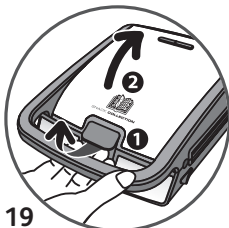
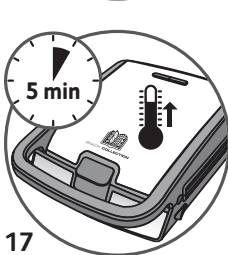
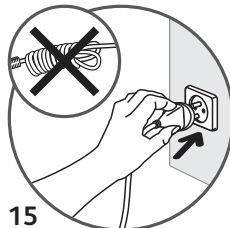
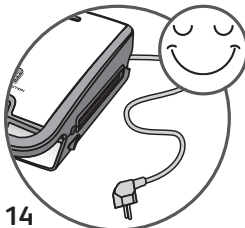

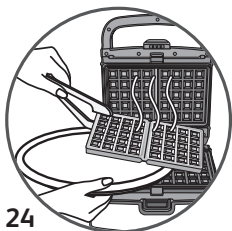

24

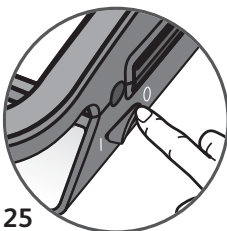

25

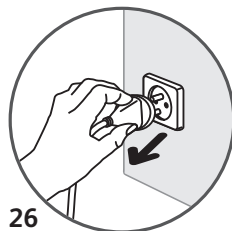

26

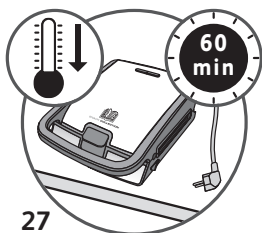

27



E



28

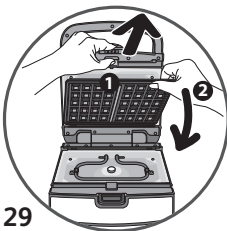

29

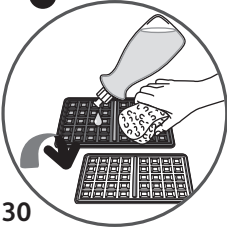
**F**

30

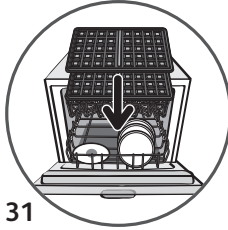

31



32

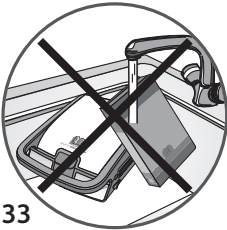

33

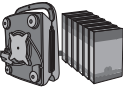

34

**G**

35

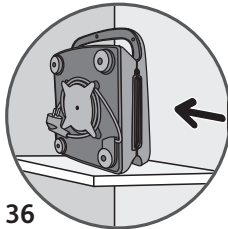
**CLICK**

36

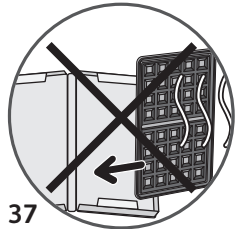

37

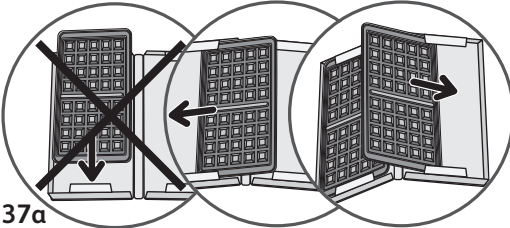

37a



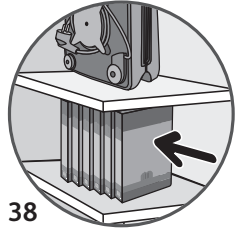

8





38



## INTERNATIONAL GUARANTEE : COUNTRY LIST

			
الجزائر <b>ALGERIA</b>	CIJA 9 rue Puvis de Chavannes - Saint Euquene - Oran	(0)41 28 18 53	1 an 1 year
<b>ARGENTINA</b>	GRUPE SEB ARGENTINA S.A Billinghurst 1833 3° - C1425DTK - Capital Federal - Buenos Aires	0800-122-2732	2 años 2 years
ՀԱՅԱՍՏԱՆ <b>ARMENIA</b>	ՓԲԸ Գրուպու ՍԵԲ-Վ, 125171 Մոսկվա, Լենինգրադյան - խեմուրի, 16A, բիք.3	(010) 55-76-07	2 տարի/ 2 years
<b>AUSTRALIA</b>	GRUPE SEB AUSTRALIA PO Box 7535, - Silverwater NSW 2128	02 97487944	1 year
<b>ÖSTERREICH AUSTRIA</b>	SEB ÖSTERREICH GmbH Campus 21 - Businesspark Wien Süd - Liebermannstr. A02 702 - 2345 Brunn am Gebirge	01 8903476	2 Jahre 2 years
<b>BELGIQUE / BELGIE BELGIUM</b>	GRUPE SEB BELGIUM SA NV 25 avenue de l'Espérance - ZI - 6220 Fleurus	070 23 31 59	2 ans 2 years
<b>БЕЛАРУСЬ / BELARUS</b>	ЗАО «Група СЕБ-Восток», Ленинградское - шоссе, д. 16А, стр. 3	017 2239290	2 года 2 years
<b>BOSNA I HERCEGOVINA</b>	SEB Développement Predstavnništvo u BiH - Vrazova 8/II - 71000 Sarajevo	Info-linija za potrošače 033 551 220	2 godine 2 years
<b>BRASIL BRAZIL</b>	SEB COMERCIAL DE PRODUTOS DOMESTICOS LTDA Rua Venâncio Aires, 433/437/447, Pompéia, São Paulo/SP	0800-119933	1 ano 1 year
<b>БЪЛГАРИЯ / BULGARIA</b>	ГРУП СЕБ БЪЛГАРИЯ ЕООД Ул. Борово 52 Г, ет. 1, офис 1, - 1680 София	0700 10 330	2 години 2 years
<b>CANADA</b>	GRUPE SEB CANADA 345 Passmore Avenue - Toronto, ON M1V 3N8	800-418-3325	1 an 1 year
<b>CHILE</b>	GRUPE SEB CHILE Comercial Ltda - Av. Providencia, 2331, piso 5, oficina 501 Santiago	12300 209207	2 años 2 years
<b>COLOMBIA</b>	GRUPE SEB COLOMBIA Apartado Aereo 172, Kilometro 1 - Via Zipaquirá - Cajica Cundinamarca	18000919288	2 años 2 years
<b>HRVATSKA CROATIA</b>	SEB Développement S.A.S. Vodnjanska 26 - 10000 Zagreb	01 30 15 294	2 godine 2 years
<b>ČESKÁ REPUBLIK / CZECH REPUBLIC</b>	GRUPE SEB ČR spol. s r. o. Jankovcova 1569/2c - 170 00 Praha 7	731 010 111	2 roky 2 years
<b>DANMARK</b>	GRUPE SEB NORDIC AS Tempovej 27 - 2750 Ballerup	44 663 155	2 år 2 years
<b>DEUTSCHLAND GERMANY</b>	GRUPE SEB DEUTSCHLAND GmbH / KRUPS GmbH Herrnrainweg 5 - 63067 Offenbach	0212 387 400	2 Jahre 2 years
<b>EESTI / ESTONIA</b>	GRUPE SEB POLSKA SP Z O.O. ul. Bukowińska 22b 02-703 Warszawa	5 800 3777	2 aastat 2 years
<b>SUOMI / FINLAND</b>	Grupe SEB Finland Kutojantie 7 - 02630 Espoo	09 622 94 20	2 Vuotta 2 years
<b>FRANCE - Includant uniquement Martinique, Guadeloupe, Réunion &amp; St. Martin</b>	GRUPE SEB FRANCE Service Consommateur Tefal BP 15 - 69131 ECULLY CEDEX	09 74 50 47 74	1 an 1 year
<b>ΕΛΛΑΔΑ / GREECE</b>	SEB GROUPE ΕΛΛΑΔΟΣ Α.Ε. Οδός Καβαλιέρητ 7 Τ.Κ. 145 64 Ν. Κηφισιά	2106371251	2 χρόνια 2 years
<b>香港 / HONG KONG</b>	SEB ASIA Ltd. Room 903, 9/F, North Block, Skyway House - 3 Sham Mong Road, Tai Kok Tsui, Kowloon - Hong-Kong	852 8130 8998	1 year
<b>MAGYARORSZÁG / HUNGARY</b>	GRUPE SEB CENTRAL-EUROPE Kft. Táviró köz 4 2040 Budaörs	06 1 801 8434	2 év 2 years
<b>INDONESIA</b>	Grupe SEB Indonesia (Representative office) Sudirman Plaza, Plaza Marein 8th Floor JL Jendral Sudirman Kav 76-78, Jakarta 12910, Indonesia	+62 21 5793 6881	1 year
<b>ITALIA ITALY</b>	GRUPE SEB ITALIA S.p.A. Via Montefeltro, 4 - 20156 Milano	199207354	2 anni 2 years
<b>JAPAN</b>	GRUPE SEB JAPAN Co. Ltd. 1F Tanakawa Muse Building, 3-14-13, Higashi Gotanda, - Shinagawa-Ku, Tokyo 141-0022	0570-077772	1 year
<b>ҚАЗАҚСТАН KAZAKHSTAN</b>	ЖАҚ «Група СЕБ-Восток» 115171 Мәскеу, Ленинградское шоссе, 16А, 3 үйі	727 378 39 39	2 жыл 2 years
<b>KOREA</b>	(유)그룹 세브 코리아 서울시 종로구 서린동 88 서린빌딩 3층 - 110-790	1588-1588	1 year
<b>LATVJA / LATVIA</b>	GRUPE SEB POLSKA SP Z O.O. ul. Bukowińska 22b 02-703 Warszawa	6 716 2007	2 gadi 2 years

# INTERNATIONAL GUARANTEE : COUNTRY LIST

			
LIEUVA / LITHUANIA	GRUPE SEB POLSKA SP Z O.O. ul. Bukowińska 22b 02-703 Warszawa	6 470 8888	2 melai 2 years
LUXEMBOURG	GRUPE SEB BELGIUM SA NV 25 avenue de l'Espérance - ZI - 6220 Fleurus	0032 70 23 31 59	2 ans 2 years
MACEDONIA	Grupe SEB Bulgaria EOOD - Office 1, floor 1, 52G Borovo St., 1680 Sofia - Bulgaria ГРУП СЕБ БЪЛГАРИЯ ДООЕЛ - Ул. Борово 52 Г, сн. 1, офис 1, 1680 София - България	(0)2 20 50 022	2 години 2 years
MALAYSIA	GRUPE SEB MALAYSIA SDN. BHD Unit No. 402-403, Level 4, Uptown 2, No. 2, Jalan SS21/37, Damansara Uptown, 47400, Petaling Jaya, Selangor D.E. Malaysia	65 6550 8900	1 year
MEXICO	G.S.E.B. MEXICANA, S.A. de C.V. Goldsmith 38 Desp. 401, Col. Polanco - Delegacion Miguel Hidalgo - 11 560 Mexico D.F.	(01800) 112 8325	1 años 1 year
MOLDOVA	ТОВ «Грун СЕБ Україна» 02121, Харківське шосе, 201-203, 3 поверх, Київ, Україна	(22) 929249	2 ani 2 years
NETERLAND The Netherlands	GRUPE SEB NEDERLAND BV Generatorsstraat 6 - 3903 LJ Veendaal	0318 58 24 24	2 jaar 2 years
NEW ZEALAND	GRUPE SEB NEW ZEALAND Unit E, Building 3, 195 Main Highway, Ellerslie, - Auckland	0800 700 711	1 year
NORGE NORWAY	GRUPE SEB NORDIC AS Tempovej 27 - 2750 Ballerup DANMARK	815 09 567	2 år 2 years
PERU	GRUPE SEB Perú Av. Camino Real N° 111 of. 805 B - San Isidro - Lima - Perú	441 4455	1 años 1 year
POLSKA / POLAND	GRUPE SEB POLSKA SP Z O.O. ul. Bukowińska 22b 02-703 Warszawa	0801 300 421 koszt jak za połączenie lokalne	2 lata 2 years
PORTUGAL	GRUPE SEB IBÉRICA SA Urb. da Matinha - Rua Projectada à Rua 3 - Bloco1 - 3° B/D 1950 - 327 Lisboa	808 284 735	2 anos 2 years
REPUBLIC OF IRELAND	GRUPE SEB IRELAND Unit B3 Aerodrome Business Park, College Road, Rathcoole, Co. Dublin	01 677 4003	1 year
ROMÂNIA / ROMANIA	GRUPE SEB ROMÂNIA Str. Daniel Constantin nr. 8 - 010632 București	0 21 316 87 84	2 ani 2 years
РОССИЯ / RUSSIA	ЗАО «Группа СЕБ-Восток», 119180 Москва, 125171, Москва, Ленинградское шоссе, д. 16А, стр. 3	495 213 32 30	2 года 2 years
SRBIJA / SERBIA	SEB Developpement Đorđa Stanojevića 11b 11070 Novi Beograd	060 0 732 000	2 godine 2 years
SINGAPORE	GRUPE SEB SINGAPORE PLY LTD. 59 Jalan Pemimpin, #04-01/02 L&Y Building - Singapore 577218	65 6550 8900	1 year
SLOVENSKO / SLOVAKIA	GRUPE SEB SLOVENSKO s.r.o. Rybničná 40 - 831 07 Bratislava	233 595 224	2 roky 2 years
SLOVENIJA SLOVENIA	SEB d.o.o Gregorčičeva ulica 6 - 2000 MARIBOR	02 234 94 90	2 leti 2 years
ESPAÑA SPAIN	GRUPE SEB IBÉRICA S.A. Almogüvers, 119-123, Complejo Ecourban - 08018 Barcelona	902 31 24 00	2 años 2 years
SVERIGE SWEDEN	TEFAL SVRIGE SUBSIDIARY OF GROUP SEB NORDIC Truckvägen 14 A, 194 52 Upplands Väsby	08 594 213 30	2 ans / Jäahre
TAIWAN	SEB ASIA Ltd. Taiwan Branch 4F., No. 37 Dexing W. Rd., Shilin Dist., Taipei City 11158, Taiwan (R.O.C.)	886-2-2833 3716	1 year
THAILAND	GRUPE SEB THAILAND 2034/66 Italthai Tower, 14th Floor, n° 14-02, - New Petchburi Road, Bangkapi, Huaykwang, Bangkok, 10320	662 351 8911	2 years
TÜRKIYE TURKEY	GRUPE SEB ISTANBULAS Beybi Giz Plaza Dereboyu Cad. - Meydan Sok. - No: 28 K.12 Maslak	216 444 40 50	2 YIL 2 years
U.S.A.	GRUPE SEB USA 2121 Eden Road - Millville, NJ 08332	800-395-8325	1 year
УКРАЇНА / UKRAINE	ТОВ «Грун СЕБ Україна» 02121, Харківське шосе, 201-203, 3 поверх, Київ, Україна	044 492 06 59	2 роки 2 years
UNITED KINGDOM	GRUPE SEB UK Ltd. Riverside House, Riverside Walk Windsor, Berkshire, SL4 1NA	0845 602 1454	1 year
VENEZUELA	GRUPE SEB VENEZUELA Av Eugenio Mendoza, Centro Lebronia, Torre - ING Bank, Piso 15, Ofc 155 Urb. La Castellana, Caracas	0800-7268724	2 años
VIETNAM	Vietnam Fan Joint Stock Company 25 Nguyen Thi Nhu Str, Ward 9, Tan Binh Dist, HCM city	+84-8 38644037 +84-8 38645830	1 year

# INTERNATIONAL GUARANTEE

**Date of purchase:** ..... / Date d'achat / Fecha de compra /  
Data da compra / Data d'acquisto / Kaufdatum / Aankoopdatum / Købsdato / Inköpsdatum /  
Kjøpsdato / Ostopäivä / Data zakupu / Data vânzării / Įsigijimo data/ Ostukuupäev / Datum  
nakupa / Sorozatszám / Dátum nákupu / Pirkuma datums / Datum Kupovine / Datum kupnje /  
Data cumpărării / Datum nákupu / Tarikh pembelian / Tanggal pembelian / Ngày mua hàng/  
Satin alma tarihi / Дата прџдажи / Дата прџдажу / Дата на закупуване / Датум на купување /  
Сатылган мерзими / Ημερομηνία αγοράς/ Ὤμερομηνία ἀγορᾶς / วันที่ซื้อ / 購買日期 / 購入日 / 구입일자 /  
خريد تاريخ / تاريخ الشراء

**Product reference:** ..... / Référence du produit / Referencia del  
producto / Referência do produto / tipo de prodotto / Typnummer des Gerätes / Artikelnummer  
van het apparaat / Referencenummer / Produktreferens / Artikkelnnummer / Tuotenumero /  
referenca produktu / Model / Gaminio numeris / Toote viitenumber / Tip aparata / Vásárlás  
kelte / Typ výrobu / Produkta atsaucnes numurs / Model proizvoda / Oznaka proizvoda / Cod  
produs / Produkt rujuklan / Referensi produk / Mã sản phẩm/ Ürün kodu / Мпдель / Мпдель /  
Мпдел на уреда / Мпдели / Κωδικός προϊόντος / 型番 / รุ่นผลิตภัณฑ์ / 產品模型 / 製品レファレン  
ス番 / 제품명 / مرجع كامل محصول / مرجع المنتج الكامل

**Retailer name & address:** ..... /  
Nom et adresse du vendeur / Nombre y dirección del minorista / Nome e endereço do revendedor /  
Nome e indirizzo delnegozio / Name und Anschrift des Händlers / Naam en adres van de dealer /  
Forhandler navn & adresse / Återförsäljarens namn och adress / Forhandler navn og adresse /  
Jälleenmyyjän nimi ja osoite / Nazwa i adres sprzedawcy / Numele și adresa vânzătorului /  
Parduotuvės pavadinimas ir adresas / Müüja kauplus ja address / Naziv in naslov trgovine /  
Tipuszmáv / Názov a adresa predajcu / Veikala nosaukums un adrese / Naziv i adresa maloprodaje /  
Naziv i adresa prodavca / Naziv i adresa prodajnog mjesta / Nume și adresă vânzător / Název a  
adresa prodejece / Nama dan alamat peruncit / Nama Toko Penjual dan alamat / Tên và địa chỉ  
cửa hàng bán/ Saticı firmanın adı ve adresi / Название и адрес прџдавца / Назва i adresa  
прџдавця / Търговки пбект / Назив и адреса на прџдавницата / Сатушының аты және  
мекен-жайы / Επωνυμία και διεύθυνση καραζήμαρος / Ὤμερομηνία ἀγορᾶς / 零售商的店名和地址/販売店の名前、住所/소매점 이름과 주소/  
ชื่อและที่อยู่ของทาง/วันที่ซื้อ / 零售商的店名和地址/販売店の名前、住所/소매점 이름과 주소/  
نام و آدرس خرده فروش / اسم وعنوان بائع التجزئة

**Distributor stamp** ..... Cachet distributeur /Sello del distribuidor /  
Carimbo do revendedor / Timbro del negozio / Händlerstempel / Stempel van de dealer /  
Forhandler stempel / Återförsäljarens stämpel / Forhandler stempel / Jälleenmyyjän leima /  
pieczęć sprzedawcy / Ștampila vânzătorului / Antspaudas / Tempel / Žig trgovine / Eladó neve,  
címe/ Razítko predajcu / Zimogs / Pečat maloprodaje/ Pečat prodavca / Pečat prodajnog  
mjesta / Ștampila vânzătorului/ Razítko prodejece/ Cap peruncit / Cap dari Toko Penjual / Cửa  
hàng bán đồng dấu/ Saticı Firmanın Kaşesi / Печать прџдавца / Печатка прџдавця / Печат на  
търговския пбект / Печат на прџдавницата / Сатушының мөрі / Σφραγίδα καραζήμαρος /  
Ὤμερομηνία ἀγορᾶς / 零售商的蓋印 / 販売店印 / 소매점 직인 /  
วันที่ซื้อ / 零售商的蓋印 / 販売店印 / 소매점 직인 /  
فروش مهر خرده / ختم بائع التجزئة

Ref. NC00127161