

Tutorial: How to control DJI RYZE Tello drone with GameSir T1d

- > [Japanese Version: チュートリアル : Tello\(ドローン\)送信機とペアリングのステップ](#)
- > [GameSir-T1d コントローラー日本語取扱説明書](#)
- > [GameSir-T1d Firmware Upgrade tool](#)

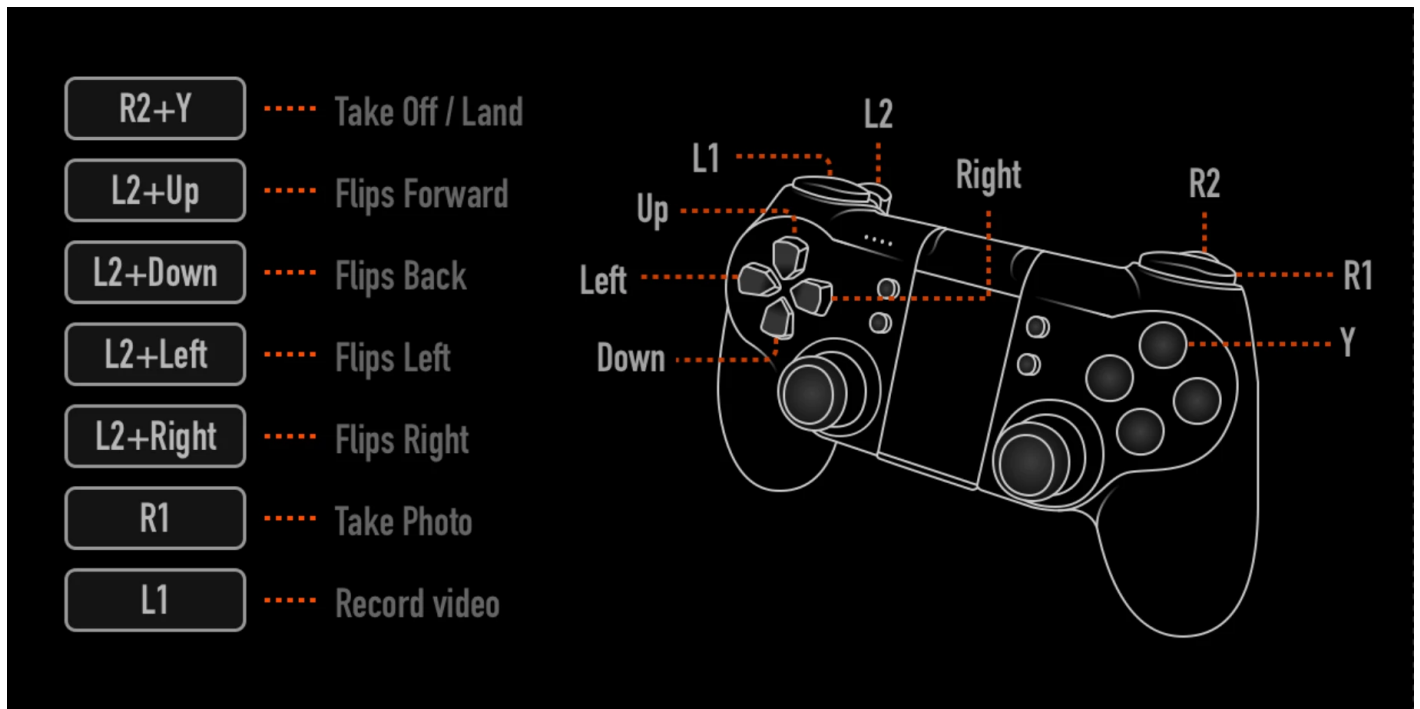

Read before try: ONLY GameSir T1d adopted to control RYZE DJI Tello

For IOS users

ONLY GameSir T1d adopted to control RYZE DJI Tello.

1. Please install the latest Tello app on your device, if already installed, please update the firmware version to the latest version by going to Tello>Setting>Advanced Setting>Firmware Version>Update.
2. On the device, go to Setting>Bluetooth and turn on the Bluetooth.
3. Press **Y+power** button on the GameSir gamepad for 2 seconds to activate the gamepad.
4. The indicator light will flash now.
5. On the Tello app, "GameSir-Games" will be displayed in "Bluetooth controller setting".
6. Tap "GameSir-Games" and pair with each other.
7. When the indicator light turns on and stay solid, the pairing is successful.

Note: if the pairing fails, please press HOME to turn off the gamepad and repeat step 3-7 to try again.

For Android users

1. Please enable the permission "Location Services (High Accuracy)" in your phone setting.

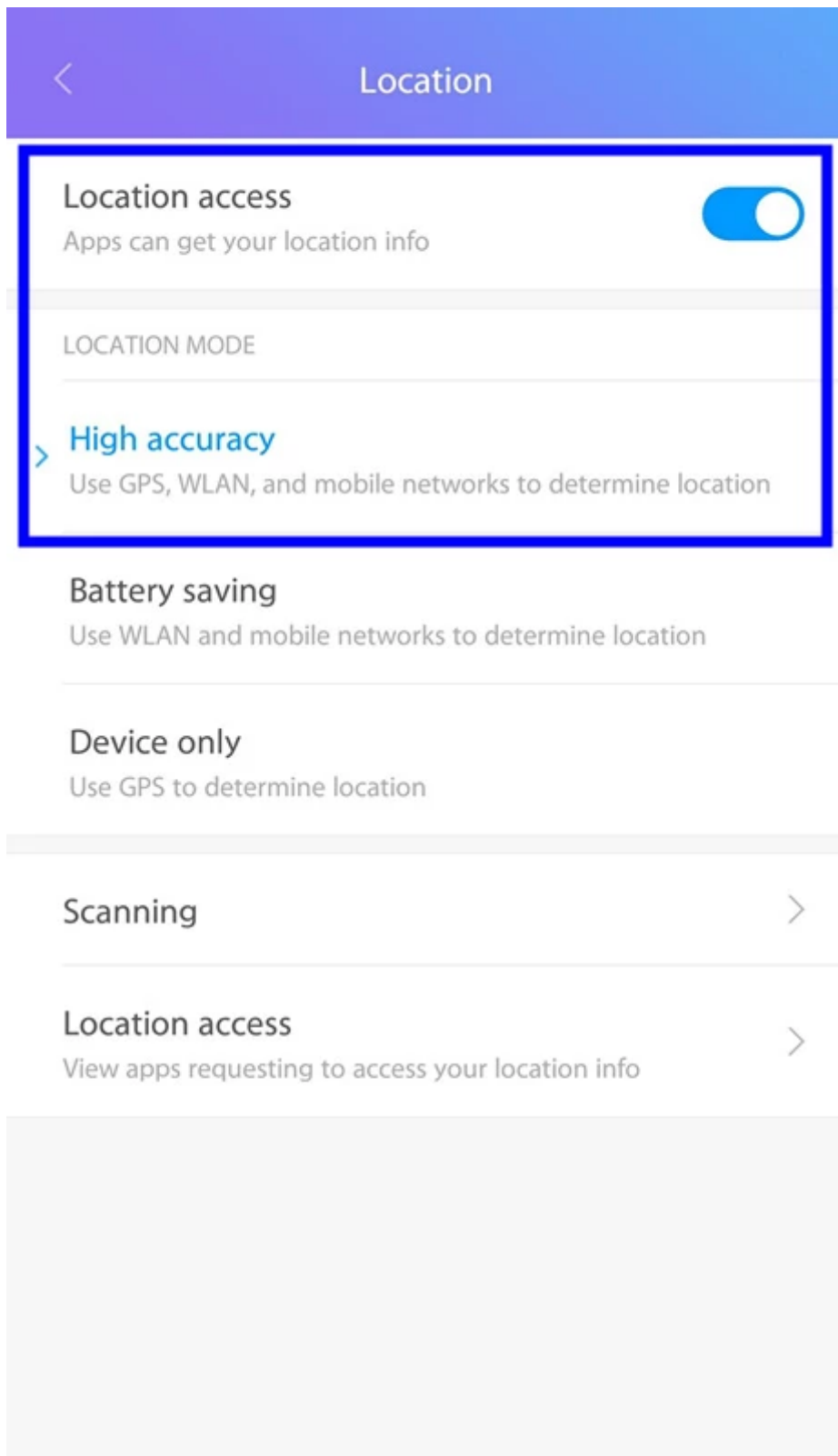

2. At the same time, you need to enable the permissions of Location, WiFi, Bluetooth of Tello APP in your phone setting.

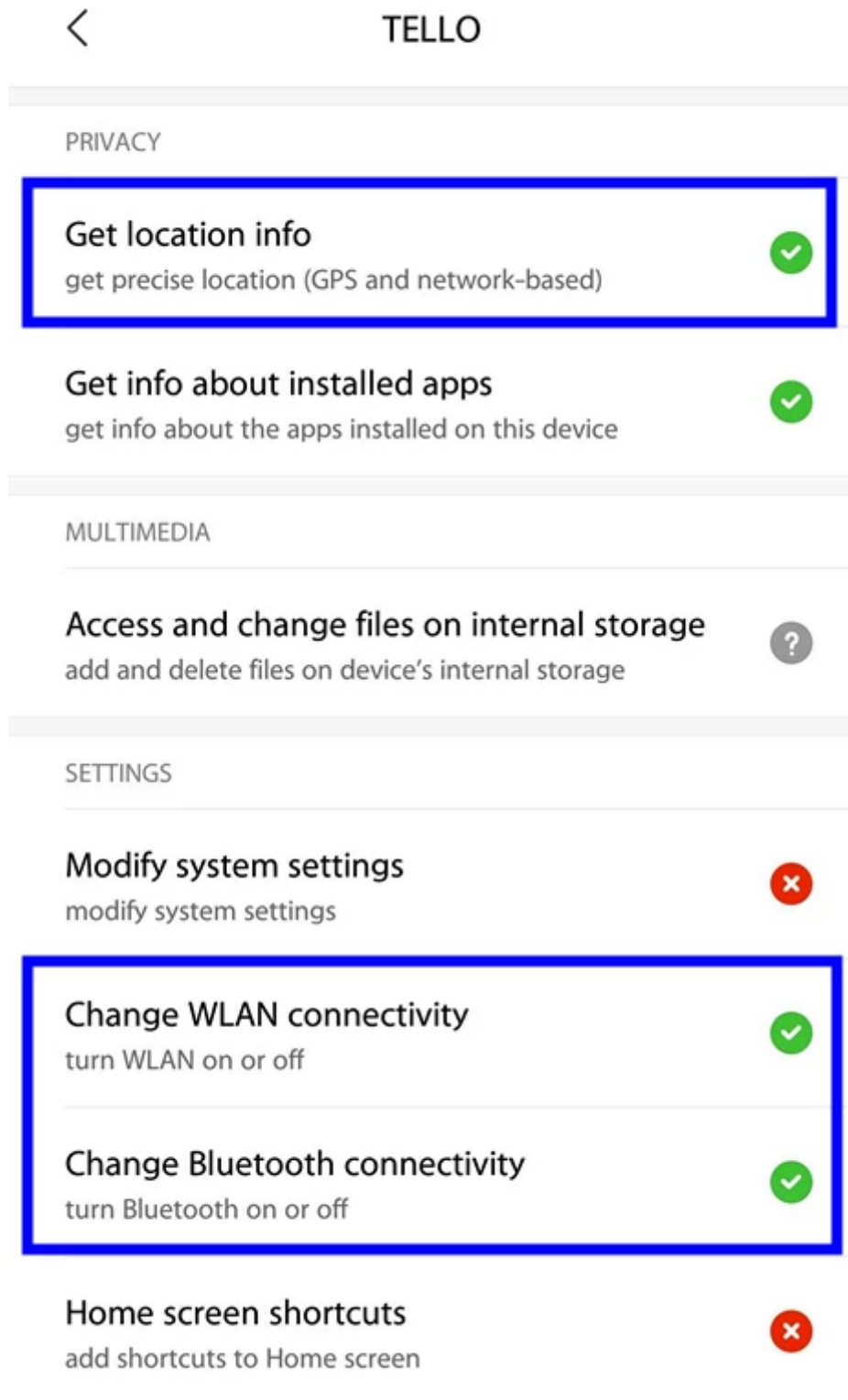

Method 1:

ONLY GameSir T1d adopted to control RYZE DJI Tello

1. Please install the latest Tello app on your device, if already installed, please update the firmware version to the latest version by going to Tello>Setting>Advanced Setting>Firmware Version>Update.
2. On the device, go to Settings>Connect>Bluetooth and turn on the Bluetooth.
3. Press **A+power** button on the GameSir gamepad for 2 seconds to activate the gamepad..

4. The indicator light will flash now.
5. On the Tello app, "GameSir-MODEL NAME GCM" will be displayed in "Bluetooth controller setting".
6. Tap "GameSir-Games" and it will pair with each other.
7. When the indicator light turns on and stay solid, the pairing is successful.

Note: if the pairing fails, please press HOME to turn off the gamepad and repeat step 3-7 to try again.

Method 2:

ONLY GameSir T1d adopted to control RYZE DJI Tello

1. Please install the latest Tello app on your device, if already installed, please update the firmware version to the latest version by going to Tello>Setting>Advanced Setting>Firmware Version>Update.
2. On the device, go to Settings>Connect>Bluetooth and turn on Bluetooth.
3. Press **B+power** button on the GameSir gamepad for 2 seconds to activate the gamepad.
4. The indicator light will flash now.
5. On the Tello app, "GameSir-MODEL NAME GCM" will be displayed in "Bluetooth controller setting".
6. Tap "GameSir-Games" and it will pair with each other.
7. When the indicator light turns on and stay solid, the pairing is successful.

Note: if the pairing fails, please press HOME to turn off the gamepad and repeat step 3-7 to try again.